

Rotonics Manufacturing Inc.

**New 1700
Gallon**

Optional 9" stackable risers offer **manhole accessibility**, allowing easier inspection of system for pumping and real estate transactions.

Threaded lids and risers have a rubber gasket to provide a **watertight seal**.

Low profile tank allows for shallow excavation to meet required installation depth.

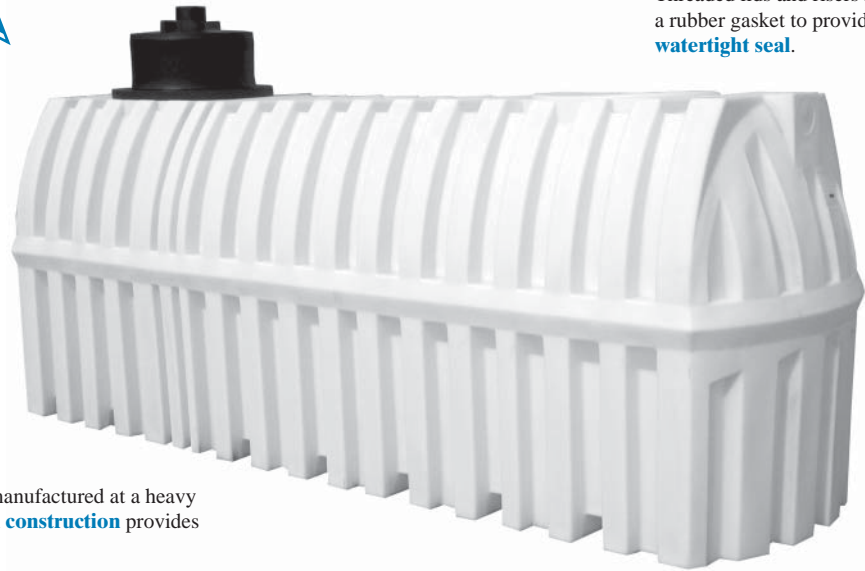

RMI Cisterns are manufactured at a heavy weight. **Thick wall construction** provides a long service life.

Durable, seamless, polyethylene tanks will not crack or corrode and are not affected by chemicals or sewer gas.

Cistern Tank *500, 1400, & 1700 Gallons*

Quality Products & Exceptional Service

RMI-D

6770 Brighton Blvd. • Commerce City, CO 80022
Phone: 303-227-9300 • Fax: 303-227-9308
E-mail: denver@rotonics.com

RMI-G

17038 South Figueroa St. • Gardena, CA 90248
Phone: 310-327-5401 • Fax: 310-323-9567
E-mail: gardena@rotonics.com

RMI-I

716 North 11th Ave. • Caldwell, ID 83605
Phone: 208-454-9271 • Fax: 208-454-3089
E-mail: idaho@rotonics.com

www.rotonics.com



Specifications



500 Gal. Cistern



1400 Gal. Cistern

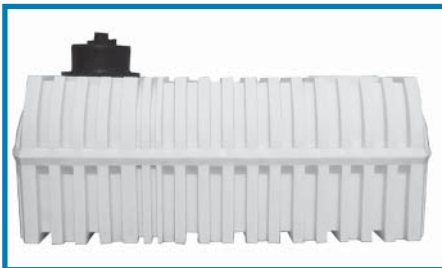

1700 Gal. Cistern



Threaded Lid



Internal Support Braces

Optimum Water Storage

- Tanks are manufactured from FDA approved High Density Polyethylene.
- Impact and corrosion resistant.
- Seamless, one piece construction.
- A large 20" entry/view port with manway risers and a sealed lid with gasket are available.
- Manufactured at a heavy weight, which provides longer service life.
- Optional 9" stackable risers assist inspectors.
- The ribbed design will support soil loads of 500 lbs/ft², often seen at 3' burial depth.
- Hold down ledge helps keep tank from floating.

Ease of Installation and Handling

- Tanks are light weight for easy transportation and installation.
- Low profile tank design minimizes excavation depth.
- Sanitary tee and pipe gaskets are optional.
- Installation instructions enclosed with each tank.

500 Gallon Cistern Tank

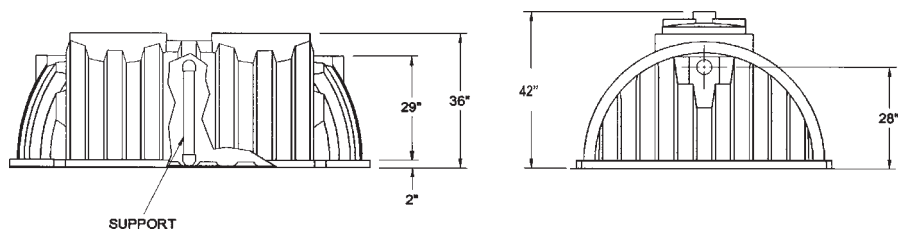

Specifications:

	Dimensions (In.)			Volume (Gallons)
	L	W	H (w/lid)	
1700	162	51	69	1700
1400	132	63	58	1400
500	92	68	42	500

Bigger is Better!

1400 Gallon Cistern Tank

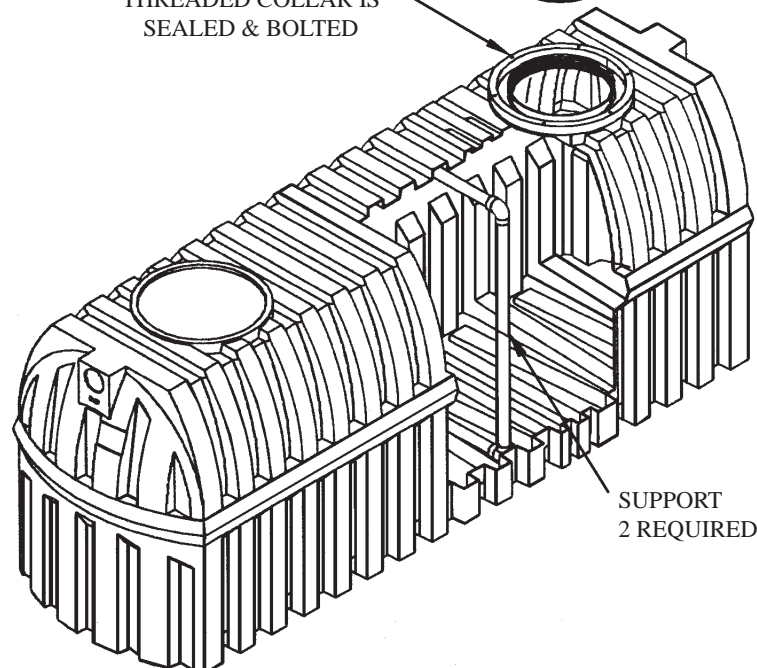
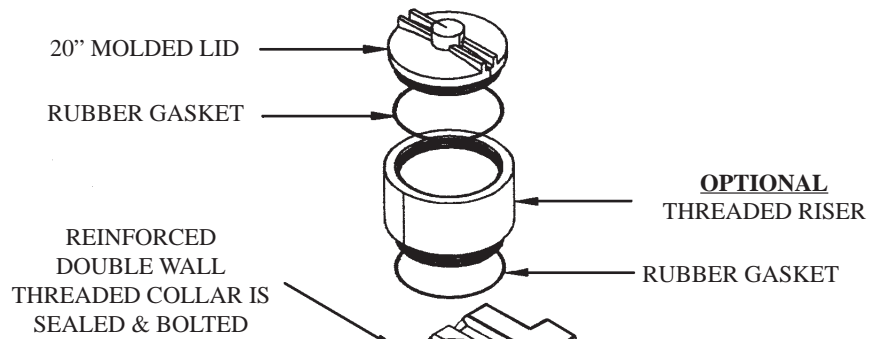
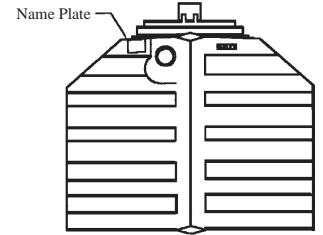
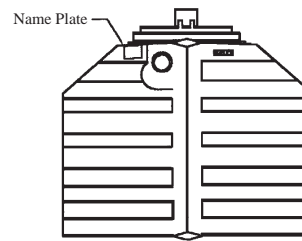
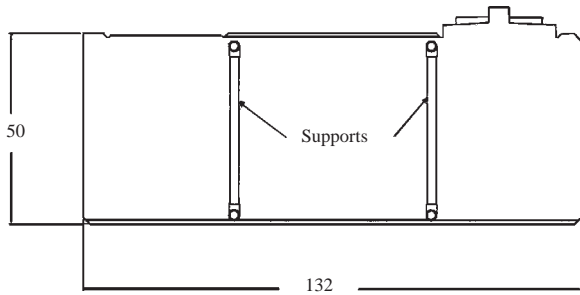

1700 Gallon Cistern Tank

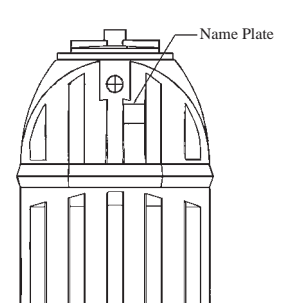
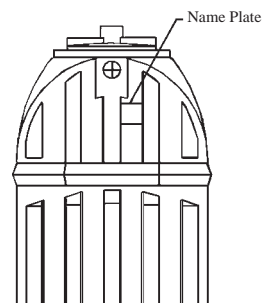
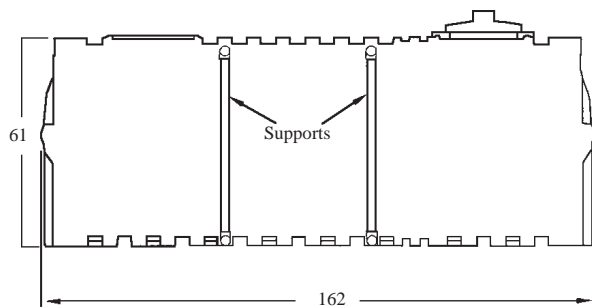

INSTALLATION OF RMI CISTERN TANKS

*RMI installation instructions do not take precedence over State and City Regulations.
Please refer to all State and City codes regarding the installation of this tank.*

1. Inspect tank for shipping damage.

2. Site requirements:

- a. Locate tank as close to dwelling as possible within local code specifications.
- b. Tank should be accessible for maintenance and pumping, but not subject to vehicle traffic.
- c. Soil conditions should be stable and not subject to high ground water, flooding, or sliding.

3. Excavation: (Will allow approximately 1' of clearance around entire tank.)

500 Gallon Cistern:	1400 Gallon Cistern:	1700 Gallon Cistern:
a. Excavate hole 9.5' long and 7.5' wide. b. The bottom of the tank inlet pipe is installed per customers specification.	a. Excavate hole 13' long and 7' wide. b. The bottom of the tank inlet pipe is installed per customers specification.	a. Excavate hole 15.5' long and 6.5' wide. b. The bottom of the tank inlet pipe is installed per customers specification.

Important Note: *Foundation should be level, compact, and free of sharp rocks. The maximum burial depth of the tank shall not exceed 3' from the top of the tank to the surface of the ground.*

4. Install threaded collar: (Does not apply to 500 gallon cistern.)

- a. Drill one 3/8" diameter hole in tank manway opening. Manway has four (4) drill points to choose from.
- b. Apply ample silicone to bottom of collar groove.
- c. Install one bolt from inside of tank and install collar onto tank. Place washer and nut onto bolt.
- d. Drill through the three (3) other collar openings into the tank and install bolts, washers, and nuts.
Do not over tighten the nuts.
- e. To prevent liquid infiltration, cover bolt heads with silicone on the inside of the tank.

5. Vertical Braces:

500 gal: Make sure the PVC vertical brace is positioned in the center rib of the tank.

1400 gal & 1700 gal: Make sure the PVC vertical braces are positioned correctly in the first available rib adjacent to the manway openings.

6. Install Manway Lid and/or Risers before backfilling. Risers come in 9" increments and may be stacked to accomplish required height.

7. Backfill with 12" maximum layers of soil. Layers must be well compacted, starting at the ends first. Fill tank with water during backfill operations maintaining equal level with soil. Do not backfill top of tank until water level is up to the outlet elevation of the tank. Mound soil over tank to provide positive drainage away from the tank and to allow for soil settling in the excavated area.

8. General Information:

- a. Do not allow any vehicle to drive over the tank.
- b. The RMI Cistern Tanks are not suitable for high ground water locations.
- c. Failure to follow RMI installation instructions and general information will void Warranty.

SEE LIMITED WARRANTY FOR DETAILS